



## 404845 OPTION-EZ3 REMOTE HARNESS J903

Contains: 404805 harness, hardware.



### Instructions:

1. Remove back cover of the indicator.  
Unplug beeper.

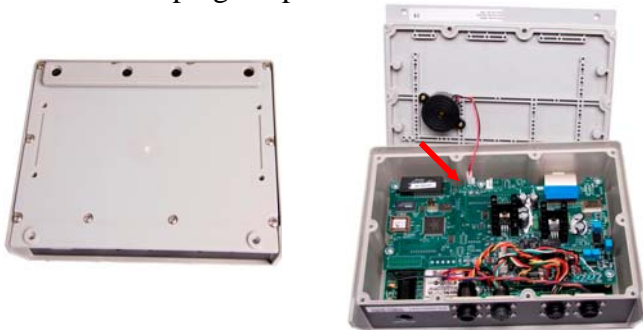

2. Cut holes for J903 connector in the bottom overlay.



3. Attach harness to bottom of housing with screws and screw plate. Check that connector is oriented correctly.



4. Connect harness to P2 on the Main circuit board. Match locking tab.

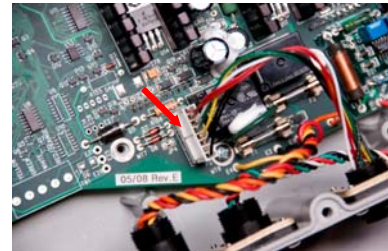

5. Reconnect beeper. Match locking tab.



6. Re-attach rear cover.